



# Lufkin heavy duty medium speed reverse reduction gear solutions



Gear unit ratio vs. input power

		KW	895	1268	1641	2013	2386	2759	3132	3505	3878	4250	4623	4996	5369	5742	6115
		BHP	1200	1700	2200	2700	3200	3700	4200	4700	5200	5700	6200	6700	7200	7700	8200
Center distance offset (in.)	17		4.26	3.96	3.35	3.00	RLS/RHS 1700										
	19			4.54	3.87	3.48	RLS/RHS 1900										
	22				4.81	4.42	4.20	3.70	RLS/RHS 2200								
	25					5.42	4.92	4.30	4.08	RLS/RHS 2500							
	28						6.17	5.92	5.60	4.97	4.71	RLS/RHS 2800					
	32							6.92	6.56	5.83	5.50	RLS/RHS 3200					
	36								7.52	6.65	6.33	5.73	5.48	RLS/RHS 3600			
	38									7.09	6.75	6.24	6.00	5.71	5.13	RLS/RHS 3800	
	41										7.33	6.82	6.52	RLS/RHS 4100			

Reverse gear and clutches rated for full power and speed.

\*Torque ratings based on 900 rpm.  
\*\*Ratios shown are maximum ratios.

# Heavy duty medium speed reverse reduction gear solutions

## Type RS-HG

Configuration: vertical shaft offset reversing

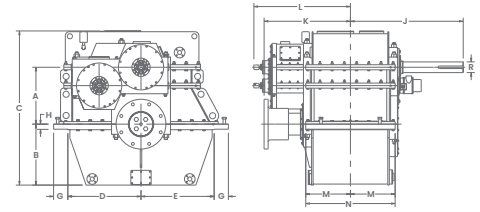

Unit	A	B	C	D	E	G	H	J	K	L	M	N	R	Weight
1700	17.0 431.8	18 457.2	50 1270	21 533.4	21 533.4	6 152.4	1.5 38.1	44 1117.6	37 939.8	41 1041.4	18 457.2	36 914.4	4.52 117.3	14,000 6,350
1900	19.1 482.6	21 533.4	53.8 1366.6	23 584.2	23 584.2	6 152.4	2 50.8	46 1168.4	40 1016	42 1066.8	20 508	40 1016	4.75 120.7	16,500 7,480
2200	22.0 558.8	23 584.2	61 1549.4	29 736.6	29 736.6	7 177.8	2.5 63.5	52.5 1333.5	43.5 1104.9	46.6 1183.6	21.25 539.8	42.5 1079.5	5.00 127	20,500 9,300
2500	25.0 635	26 660.4	68 1727.2	36 914.4	36 914.4	7 177.8	2.5 63.5	64 1371.6	42 1066.8	47.1 1196.3	21.5 546.1	43 1092.2	5.25 133.4	24,500 11,110
2800	28.0 711.2	30 762	75.5 1917.7	43 1092.2	43 1092.2	7 177.8	2.5 63.5	55.5 1409.7	32.5 1079.5	47.6 1209	22 558.8	44 1117.6	5.25 133.4	28,500 12,930
3200	32.0 812.8	33 838.2	85 2159	44 1117.6	44 1117.6	7 177.8	2 50.8	52 1320.8	43 1092.2	50 1270	24 609.6	48 1219.2	6.00 152.4	34,000 15,420
3600	36.0 914.4	38 965.2	94 2387.6	46 1168.4	46 1168.4	7 177.8	2.5 63.5	50 1270	45 1143	54 1371.6	25 635	50 1270	6.50 165.1	37,000 16,780
3800	38.0 965.2	40 1016	98 2489.2	48 1219.2	48 1219.2	7 177.8	2.5 63.5	50 1270	47 1193.8	56 1422.4	27 685.8	54 1371.6	6.75 171.5	39,600 17,920
4100	41.0 1041.4	42 1066.8	102 2590.8	44 1117.6	44 1295.4	7 197.8	2.5 63.5	56 1422.4	50.5 1282.7	55 1397	30 762	60 1542	6.75 171.5	45,000 20,410

\*Dimensions may be altered to fit customer's request

## Type RHS-HG

Configuration: horizontal shaft offset reversing

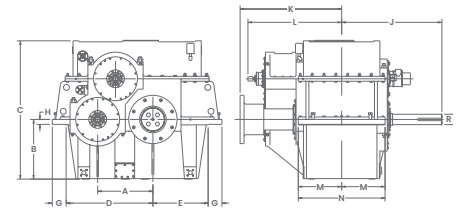

Unit	A	B	C	D	E	G	H	J	K	L	M	N	R	Weight
1700	17.0 431.8	18 457.2	48 1219.2	29 736.6	16 406.4	6 152.4	1.5 38.1	44 1117.6	37 939.8	41 1041.4	18 457.2	36 914.4	4.62 117.3	14,000 6,360
1900	19.0 482.6	21 533.4	52 1295.4	32 812.8	19 482.6	6 152.4	2 50.8	46 1168.4	40 1016	32 1066.8	20 508	40 1016	4.75 120.7	16,500 7,480
2200	22.0 558.8	24 609.8	55.4 1407.2	36.8 934.7	22 558.8	7 177.8	2 50.8	49.2 1249.7	43.7 1110	50 1270	23.6 599.4	47.1 1196.3	5.00 127	20,750 9,410
2500	25.25 641.4	28 711.2	64.6 1640.8	41.3 1049	26 660.4	7 177.8	2 50.8	50 1270	42.5 1079.5	47.4 1204	21.9 556.3	43.8 1112.5	5.25 133.4	26,000 11,790
2800	28.0 711.2	30.3 769.6	70.1 1780.5	44 1117.6	28 711.2	7 177.8	2.5 63.5	55.5 1409.7	49.5 1267.3	47.6 1209	22 558.8	44 1117.6	5.25 133.3	30,300 13,740
3200	32.0 812.8	33.5 850.9	71.6 1818.6	49 1244.6	33 838.2	7 177.8	2 50.8	62.3 1582.4	43 1092.2	50 1270	23.1 586.7	46.3 1176	6.00 152.4	32,000 13,510
3600	36.0 914.4	38 965.2	78 1981.2	54 1371.6	38 965.2	7 177.8	2.5 63.5	50 1270	45 1143	54 1371.6	25 635	50 1270	6.50 165.1	35,500 16,100
3800	38.0 965.2	40 1016	81.3 2065	56.5 1435.1	40.5 1028.7	7 177.8	2.5 63.5	50 1270	47 1193.8	56 1422.4	27 685.8	54 1371.6	6.75 171.5	37,000 16,780
4100	41.0 1041.1	42.3 1074.4	83.6 2123.4	64 1524.6	64 1079.5	6 152.4	2 50.8	58 1473.2	50.5 1272.7	59.6 1513.8	30 762	60 1524	6.75 171.5	39,000 17,690

Dimensions shown are average values but may vary depending on ratio, horsepower, and customer requirements.

Black dimensions/weights are in inches/pounds.

Green dimensions/weights are in millimeters/kilograms.

Note: Above dimensions are not to be used for unit installation. Use only a certified installation print.

\*Dimensions may be altered to fit customer's request

